

Quick Start Installation of SubliJet IQ for the Epson 4000 PRO



Do not install the Epson Inks provided with the printer. Please call Sawgrass Technical Support if you need assistance installing the SubliJet IQ inks.

Installing SubliJet IQ Cartridges

1. Press the Power button to turn on the printer.
2. Open the ink compartment covers by pressing the door to release the latch.

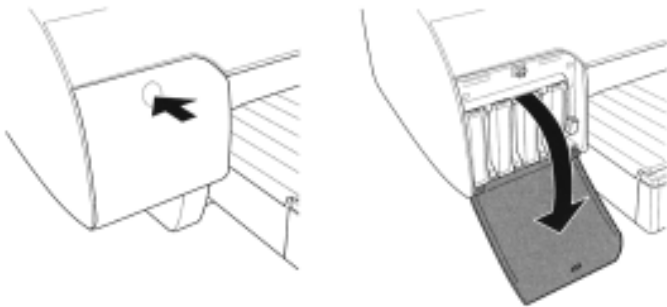

3. Raise both ink levers. These are located on the right side of each ink cartridge compartment.

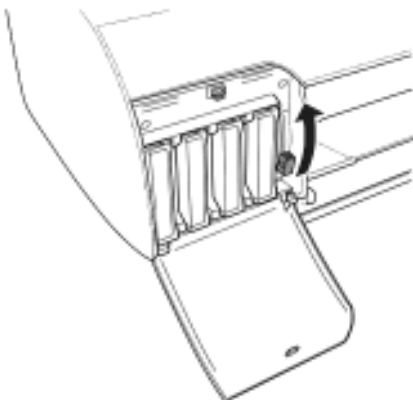

4. Install the ink cartridges into the color-coded slots. When installing the dual sets of ink, the color order of both compartments is K, C, M, Y. The cartridge label should be facing left as the cartridge is inserted into it's slot.

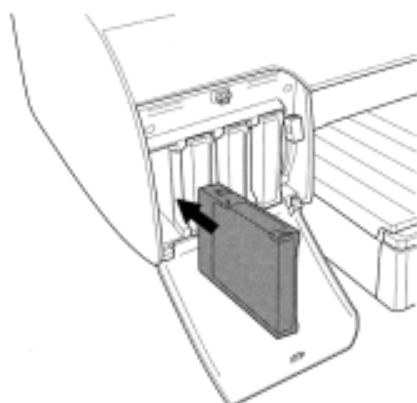

5. After all 8 cartridges are installed, lower the ink levers. The printer will begin charging the ink-delivery system and the pause light will flash.

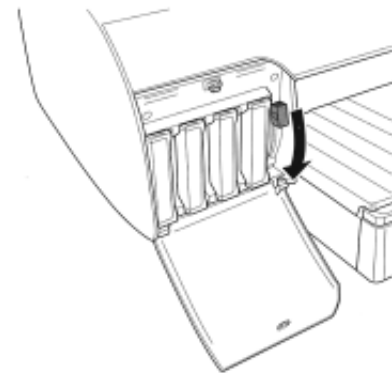

6. After approximately 2 minutes, ink lever messages will appear on the LCD. Follow the LCD prompts to raise or lower ink levers.
7. Charging is complete when READY appears on the LCD screen. If using the standard size cartridges, close the ink compartment doors. If using the extended cartridges, the doors will remain open.

Heat Transfer Instructions for SubliJet IQ

SURFACE	TRANSFER TIME SUBLIJET IQ	TEMP	PRESSURE	REMARKS
POLYESTER/ MOUSEPADS	45 seconds	400°F	40 psi	
METAL (Universal Woods)	60 seconds	400°F	40 psi	Use absorbent, remove plastic
METAL (Other) White, Silver, Gold	60 seconds	375°F - 400°F	40 psi	Time varies with metal manufacturer (<i>Contact your reseller for correct time and temperature</i>) Place absorbent sheet on bottom plate of heat press. Then place transfer paper face up on top of the absorbent. Next place substrate face down on top of the transfer paper. <i>Remove paper from substrate immediately after transferring for best results.</i>
UNISUB	75-85 seconds	400°F	40 psi	Remove Plastic
FR PLASTIC	75-80 seconds	400°F	40 psi	Remove Plastic
SOFT L'INK	35 seconds	400°F	40 psi	Press for 5 secs to eliminate moisture, use Teflon sheet between sides of shirt to prevent "blow through"
CERAMIC	150-210 seconds	350- 400°F	40 psi	Time varies with press, use green tile mat for ceramic tile