

## Manual Cleaning Procedures for the Epson 4000 Series

Preferably, with the Power Off of your printer, open the top cover and reach into the printer as pictured below and unlock the print head.

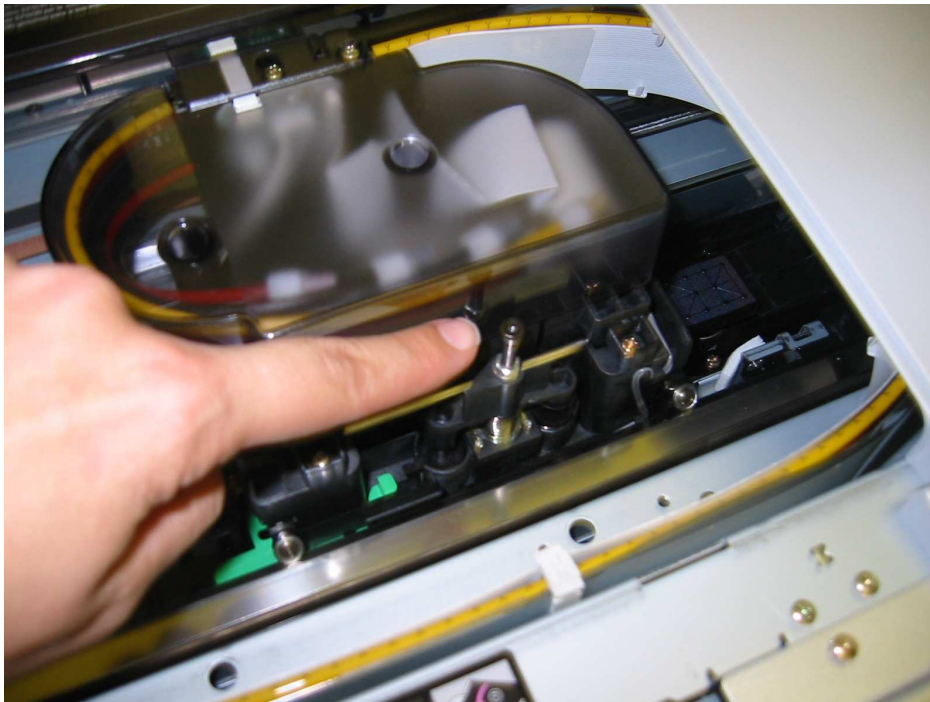

To unlock the print head, reach under the right side of the printer cover and press the release button, seen here, and move the print head to the left.



Move the print head all the way to the left side of the printer.



Apply some Simple Green to a soft, lint free cloth and wipe off the flushing box to remove any excess ink or other debris. Do not wipe off the Capping Assembly. After you are able to see the metal mesh pattern on top of the flushing box, apply some more Simple Green to pads.

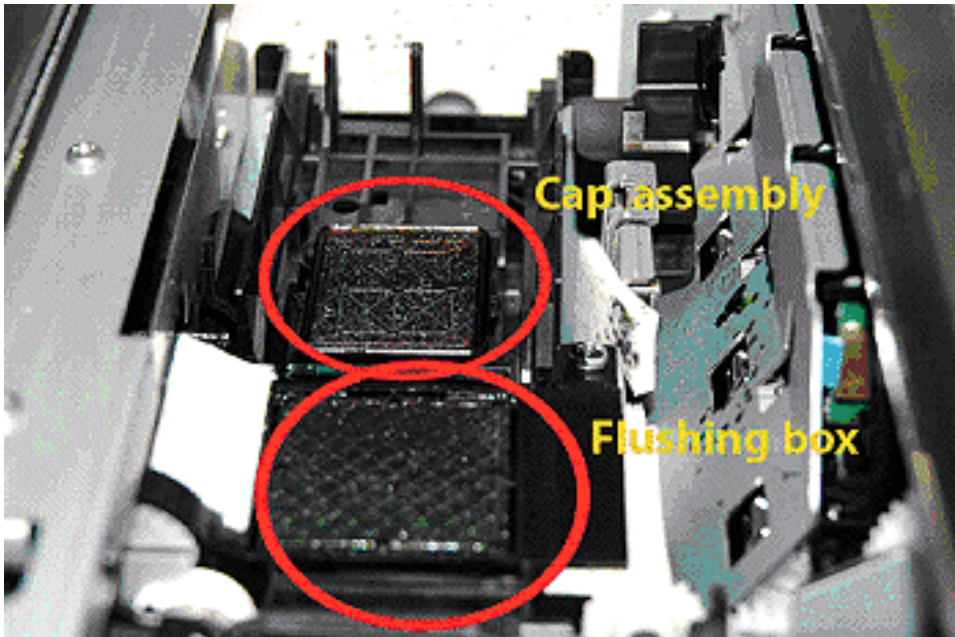

**Note:** If the flushing box is excessively dirty it may be removed and flushed under warm running water. Be extremely careful when removing this part which is held in place by only one screw. Do not drop the screw into the printer or misplace it otherwise.

Again using a Simple Green spray or saturate the capping station. Do not wipe the capping station.

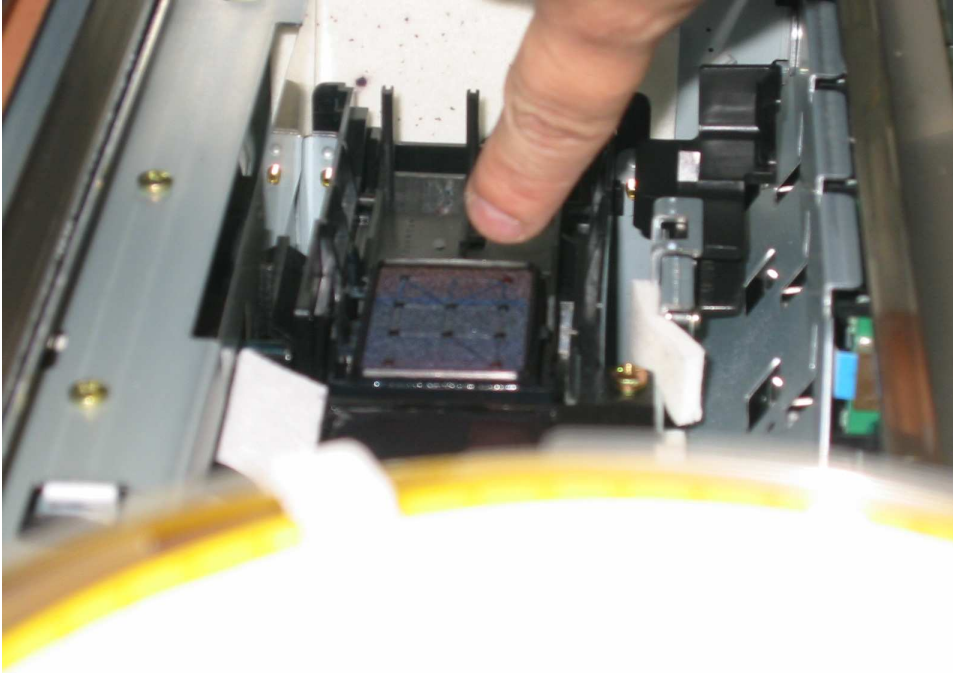

Locate the wiper blade and clean it with a cotton swab moistened with Simple Green. Most of the wiper blade is located behind the clear plastic shield, which may be difficult to clean. If you use a long cotton swab you'll be able to reach further back and clean the blade more thoroughly. The blade is split down the middle so be sure to clean both sides of the blade and inside the split.

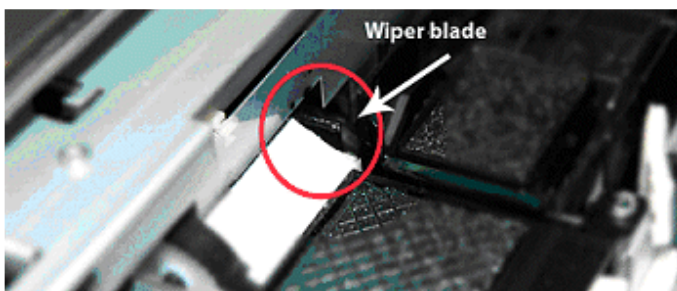

Let the saturated pads soak for approximately 15-20 minutes. Move the print head back over to the right on top of the components that have been cleaned and let it sit for another 15 minutes.

After this period of rest, press and hold down the printer's Menu button for 2 or 3 seconds to perform a cleaning. If the display shows Power Clean Y or N, the answer is N. After it has run the standard cleaning try to print a nozzle check (do not select an auto nozzle check). Repeat this step once or twice as necessary until you get a good nozzle check.