

1400 BULK INK SYSTEM INSTALLATION INSTRUCTIONS

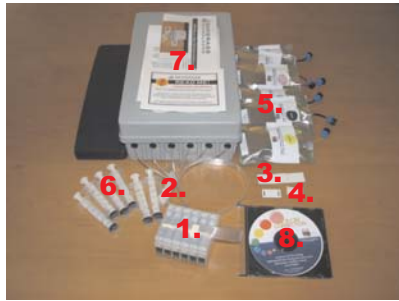

Before you install the ArTainium bulk ink system, you should set up the Epson 1400 printer with the Epson supplied inks and driver. Conduct a nozzle check to make sure that the system is working properly. Record the alpha-numerical value from the nozzle check (on far left side of the page). This is your firmware number which will be needed later on in the ArTainium ink profile installation. Once this is completed you can begin the ArTainium installation process. Note: Please remove the Epson cartridges before moving to step number one.



Please read this document thoroughly before installing the system to prevent voiding your warranty.

Check to ensure you have all components shown in the picture:

1. Ink Cartridges + Tubes
2. Tubing Clip
3. Tubing Clip Insert
4. Side Clip
5. 6x ink Bags
6. Priming Syringes - one for each color
7. Ink Box



1. Remove the black end cap from each of the ink bags and each of the ink box connectors and discard.

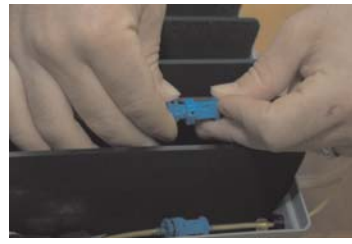

2. Insert the ink bags into the ink box by placing them in the section that is marked with the appropriate color bead.

3. Connect the ink bags to the box by snapping the bag connector into the ink box connector. As soon as the connection is made, ink should start flowing into the cartridges. If ink does not flow into the cartridges, steps 8 & 9 will show you how to manually prime.

1400 PRINTER SETUP INSTRUCTIONS



1. Place the printer on a level surface next to the bulk ink system.



2. Turn the printer on and press the cartridge replacement button.



3. The cartridge bay will shift into the remove position so that the cartridge lid can be taken off.



4. To remove one side of the cartridge lid, you must use a screwdriver to pry the latch free.



5. To remove the other side of the cartridge lid, pull the cartridge up and break the tab.



6. Once the cartridge lid is removed, slide the cartridge bay over to the left side as shown above so that the ink cartridges can be installed.

1400 BULK INK SYSTEM INSTALLATION INSTRUCTIONS CONTINUED



7. Push the cartridges into the cartridge bay until they snap into place. Some pressure may be needed to ensure proper placement in the cartridge bay holder.



8. It may be necessary to manually prime the ink cartridges. This is accomplished by carefully removing the small rubber stopper from the top of each ink cartridge. **Be careful not to lose the stopper as it will need to be reinstalled for the cartridge to work properly.**



9. Depress the syringe plunger all the way to remove all of the air from the syringe. Firmly insert the tip of syringe into the stopper hole on the top of the ink cartridge as shown above. Slowly draw out the plunger. Ink will begin to flow into the cartridge. Remove the syringe tip once the ink has started to flow into the syringe. Replace the plastic stopper. (Note - It can take up to a minute to fill each ink cartridge. Repeat the priming instructions for all the remaining ink cartridges). **Rinse the syringes with water and store in a closed plastic bag for when you need to replace bulk ink bags.**



10. Remove the adhesive tab from the tube clip and place it on the printer over the 3rd setup graphic from the right.



11. Place the cross bar over the adhesive tab to secure the tube clip into place.



12. Place the side clip on the printer so that it is even with the ink tubing coming from the cartridge bay.



13. Place the top of the side clip over the tubing to secure it to the printer.



14. Press the cartridge replacement button to send the carriage back to the starting point. It may take up to a minute for the printer to cycle through it's set up. This is complete when the on/off switch shows a non-blinking green light.



Congratulations! You have successfully installed a 1400 Bulk Ink System.

NEXT STEPS:

- Perform a nozzle check from the Epson driver utility. A few cleanings may be necessary to prime the system. Do not perform excessive cleanings, no more than 3 should be necessary to prime the system.
- Insert the ArTainium Color Correction CD for color profile for instructions on configuring your Epson Printer for ArTainium ICC profiles.

PLEASE NOTE:

- During printing you must either leave the printer lid open or remove the printer lid entirely.
- Do not raise the ink box higher than the printer.